

## Installation Instructions (cont.)

7. Remove the protective layer from the vertical strip of tape in the corner ONLY. With someone helping, adhere the smooth side of the to wall covering to the tape.

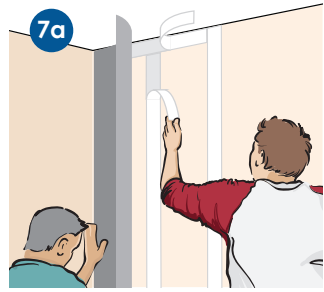

Now remove the protective layer from the other strips of tape. Carefully adhere the wall covering to the tape, smoothing as you go. **NOTE: Half of the outermost strip of vertical tape should remain exposed for the next sheet to be adhered.**



8. Measure the next 24" from the installed sheet of wall covering. Mark the wall as you did for the first sheet. Apply the next vertical strip of double-sided tape, centered on the 24" mark. Again, do not remove the protective covering. Apply tape horizontally at the ceiling and the floor as you did in step 7. Keep protective covering on tape. **NOTE: Walls can be imperfect so measure for each sheet of wall covering to ensure proper fit.**



9. Install a third piece of tape vertically down the center of the wall between the next two strips, keeping the protective cover on the tape.

Position the next sheet of wall covering flush with the previous sheet. Try not to leave a gap. Adhere covering to the exposed portion of the tape from the first section.

Remove the protective layer from all other strips of tape. Carefully adhere barrier to the tape, smoothing as you go. Once again, leave half of the outermost strip of tape exposed for the next sheet.

10. Use a rolling pin or similar object from around your home to flatten the seams and smooth out the bubbles. Apply painter's tape to any residual adhesive on the cardboard. Cut any stray fibers with a utility knife.

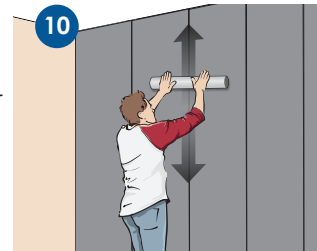

11. Use caulk to fill any gaps in the seams and corners.



12. Once you have finished hanging the barrier, it is time to prime and paint.

Clean any spots on the wall before priming. Select the primer and paint color. Then, prime and paint your wall covering as you would any other wall, following the directions on your primer and paint.

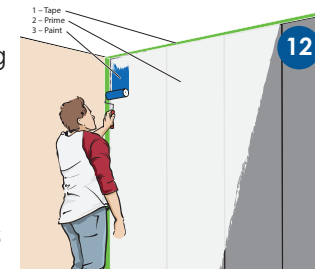

Made in the USA by Ronald Mark Associates, Inc.  
1227 Central Avenue, Hillside, NJ 07205  
[www.xtrmply.com/soundsafe](http://www.xtrmply.com/soundsafe)

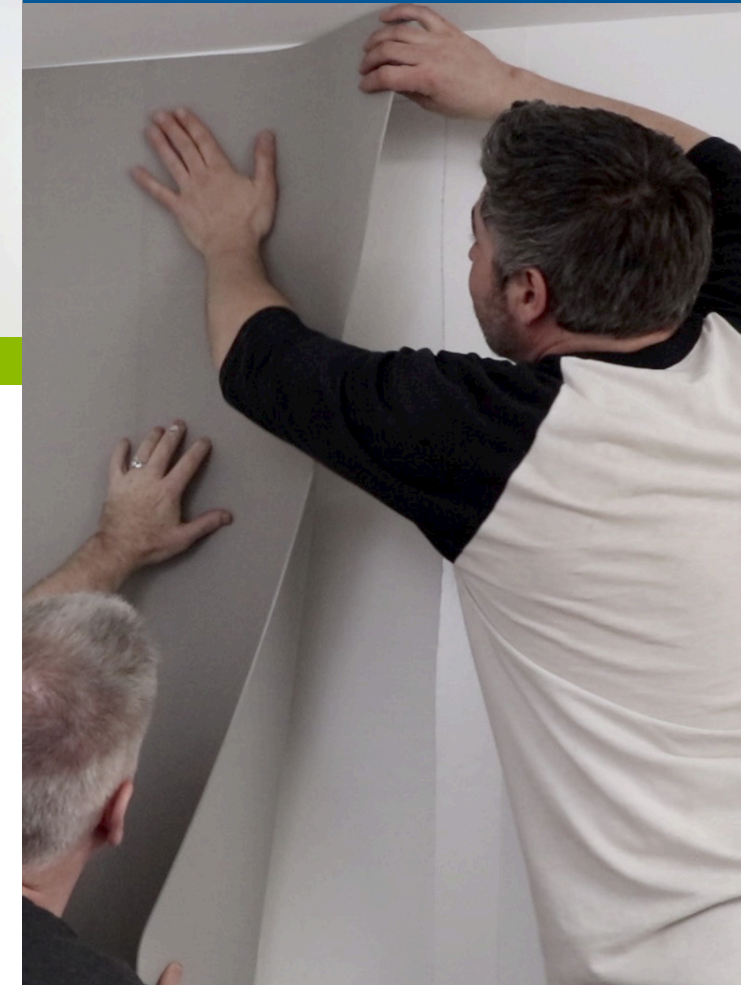

## MLV Acoustic Barrier Installation Guide

Our acoustic wall covering allows you to lead a more peaceful, productive lifestyle in your very own home.



Similar to wallpaper, **XTRM Ply® SoundSafe™ Acoustic Wall Covering** is a material designed to adhere to your walls. However, unlike traditional wall coverings, our acoustic product reduces noise transmission from one room to another or from the environment outside the home. This unique sound barrier is created when SoundSafe HOME is applied to your walls using industrial-strength, double-sided tape. Our wall covering is an ideal solution to help drown out noisy neighbors, dim outdoor sound transmissions and improve any indoor environment. With **SoundSafe™ Acoustic Wall Covering**, you can lead a more peaceful, productive lifestyle in your very own home.



## Applying SoundSafe

### XTRM Ply® SoundSafe Acoustic Wall Covering

can easily be installed over existing wall surfaces. It is a smooth, reinforced High Density Mass Loaded Vinyl (MLV) specially designed to reduce sound transmissions between existing walls.

This guide provides the necessary materials needed for installation, as well as, step-by-step installation instructions.

**For further information about installation or purchasing additional products, please visit our website at [www.xtrmply.com/soundsafe](http://www.xtrmply.com/soundsafe). Installation video can also be found online.**

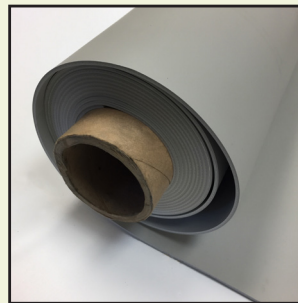

## Materials Needed for Installation

- T-Square
- Tape Measure
- Various Screws
- Paper Towels
- Painting Supplies
- Pencil
- Utility Knife
- Cleaning Solution
- Caulk/Caulking Gun

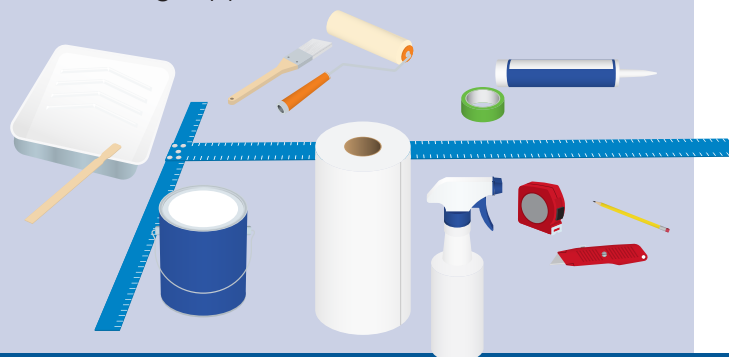

## Installation Instructions

1. Begin by unrolling the SoundSafe Acoustic Wall Covering and letting it sit overnight.

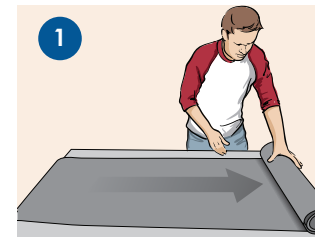

2. Measure the height of your wall. Then, measure the SoundSafe Acoustic Wall Covering. Once you have the wall covering marked correctly, cut to size.

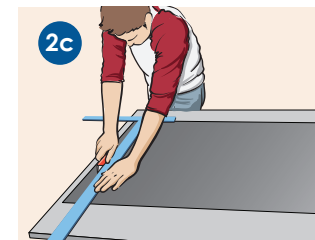
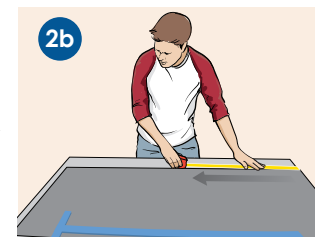
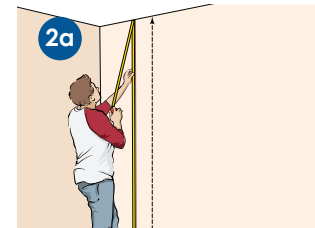

3. Apply double-sided tape vertically at the corner of the wall you will be covering with SoundSafe. **Do not remove the protective covering yet.**



4. Measure 24" from the corner of the wall. Mark the wall in several places from the top of the wall to the bottom.

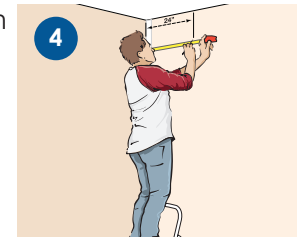

5. Apply double-sided tape horizontally at the top of the wall and the bottom. Then install tape vertically, centering on the 24" marks from top or bottom of wall. Install a third piece of tape vertically down the middle of the wall between the corner and the outside vertical tape. **Do not remove the protective covering.**

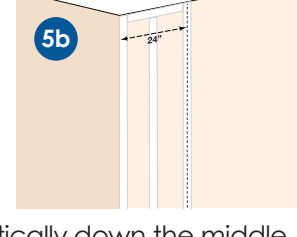
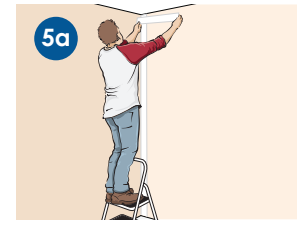

6. Identify and clean the smooth side of the wall covering. This will be the side you adhere to the wall.

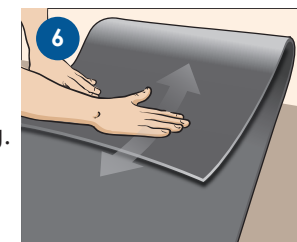

*Instructions continue on reverse side.*